



FMC : Compact Gas Filter

### Technical Data

- \*Threaded connection:  
DN 15 - DN 50 according to EN10226
- \*Max. working pressure:  
6 bar
- \*Environment temperature:  
-20 to +70 degree celsius
- \*Filtration:  
10 micron

### Description

It is a device that prevents the passage of particles of dust or debris brought by the gas ,protecting the regulation and safety device.

### Dimension

Threaded size	A	B	KG	Filtering surface
DN 15 (1/2")				
DN 20 (3/4")	70	63	0.35	3890 mm2
DN 25 (1")				

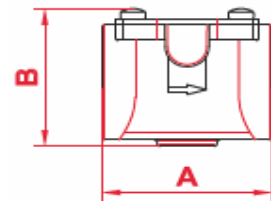

### Drawing

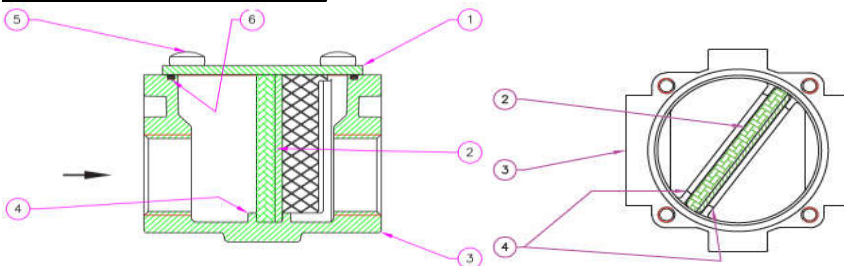

- 1.-Cover / Bottom
- 2.-Filtering organ
- 3.-Body
- 4.-Slotting guides
- 5.-Fixing screws
- 6.-Seal O-Ring

### Installation

**It is always important to read carefully the instruction sheet of each product.**

**Warning! all installation/maintenance work must be carried out by skilled staff.**

- \*The gas supply must be shut off before installation .
- \*Check that the line pressure does not exceed the maximum pressure stated on the product label.
- \*The filter is normally installed upstream the regulation organs and the interception device. It mustbe installed with the arrow (on the body valve) towards the user.
- \*It can be installed in any position without compromising the correct working.
- \*During installation take care not to allow debris or scraps of metal to enter the device.
- \*Check that the pipeline thread is not too long as overlong threads may damage the body of the device when screwed into place.
- \*Always check that the system is gas-tight after installation.

